



CONNOR[®] SPORTS

**HARDWOOD
SYSTEMS**

SPORTBOND PLUS DIN[™]

FLOATING SYSTEM

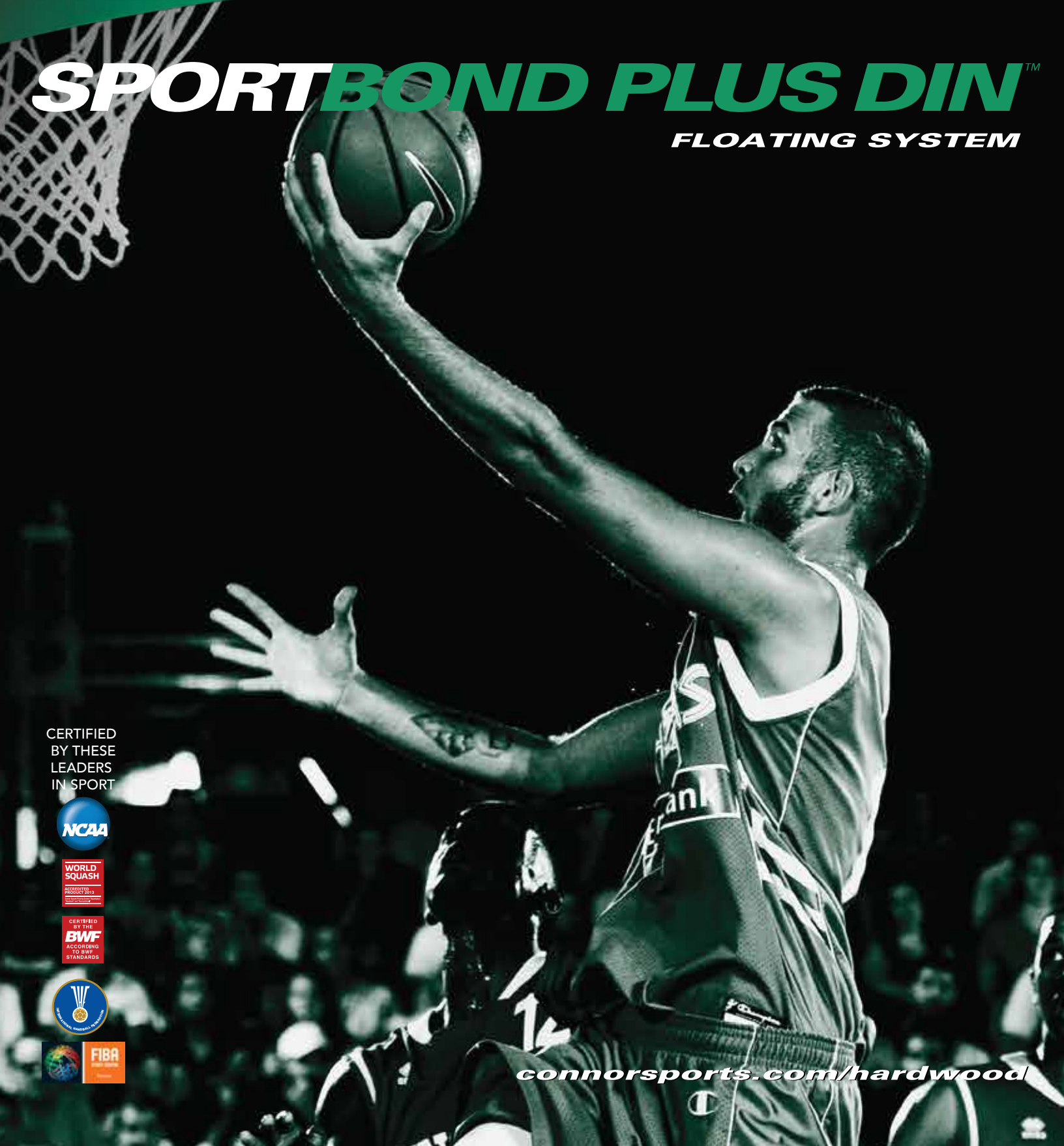

CERTIFIED
BY THESE
LEADERS
IN SPORT



connorsports.com/hardwood

SPORTBOND PLUS DIN™ FLOATING SYSTEM

Connor Sports • 800.283.9522 • 847.290.9020 • info@connorsports.com • connorsports.com/hardwood



Parquet type flooring provided in the SportBond Plus system is manufactured from primarily vertical grain maple to decrease dimensional shrinkage and growth associated with seasonal conditions.



The double plywood subfloor can be supported by numerous resilient pad options, with flooring arranged in a straight lay or alternating square pattern.

SPORTBOND PLUS DIN FLOATING SYSTEM

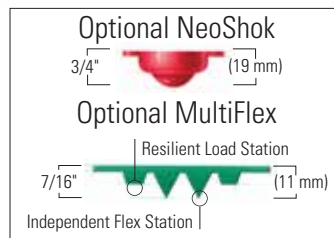

Performance Status:
Meets or exceeds
all the requirements
of DIN 18032, part 2

RESILIENCE

Rezill 7/16" (11 mm)
Pads

FLOORING

MFMA Northern
Hard Maple

SUBFLOOR CONSTRUCTION

Two layers of 15/32" (12 mm)
APA rated Plywood subfloor

Slab Depression: 7/16" (11 mm) pad: 3/8" (10 mm) flooring – 1 7/8" (48 mm), 1/2" (13 mm) flooring – 2"
3/4" (19 mm) pad: 3/8" (10 mm) flooring – 2 1/8" (54 mm), 1/2" (13 mm) flooring – 2 1/4" (57 mm)

SportBond Plus Wall Base Detail

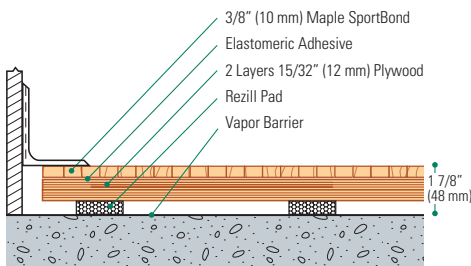

SportBond Wall Base Detail

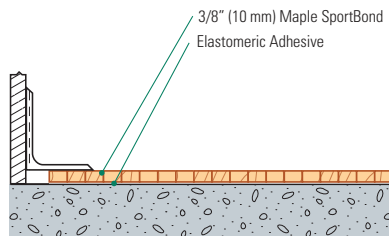

SportBond Flex Wall Base Detail

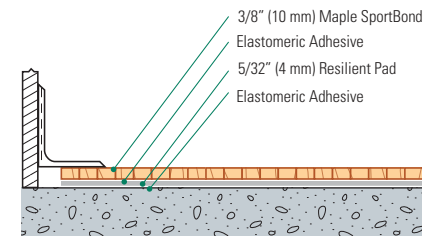

Manufacturing:
ISO 9001:2008
CERTIFIED
ISO 14001:2004
CERTIFIED



Recycled Contribution:
SportBond Plus DIN Subfloor
System includes components
with recycled content



Testing Laboratory:
United States Sports
Surfacing Laboratory



Certified Testing:
ISSS Scientific
Body Membership



Green Status
Managed Forests,
Certification Available



Environmental Product Declaration
The First Sports Floor Manufacturer to Publish
UL Certified Product-Specific Environmental
Performance In Compliance with LEED V.4